

# VARM® INSTRUCTION MANUAL

**PROTECT YOUR WC FROM VIRUS, BACTERIA AND PONGS COMING FROM THE SEWERAGE  
VARM VIRUS FREE TOILET SEAT LEAD**

Varm disinfection system for WC has been studied for the disinfection of the WC, with an easy application procedure. It is suitable to be applied to the most of toilet seat cover series. It allows to eliminate up to 99% of all viruses and bacteria coming from the sewer pipes up to bathroom sanitary drainages' pipes, by providing the highest level of hygiene and safety in the use of WC.

Dear Customer, Thank you for your recent purchase of Varm disinfection system for Wc, we are sure you will be satisfied of the present product. Be sure to read this Instruction Manual before using your product and keep it in a safe place for future references.

## HOW TO USE

**Varm Disinfection system starts to function when the toilet seat cover is closed and the UV-C lamp starts its work by eliminating all viruses, bacteria and pongs. PAY ATTENTION TO: PLEASE AVOID THE DIRECT EXPOSURE TO THE UV LAMP**

## INSTALLATION PROCEDURE

Installation procedure for the application of Varm disinfection system on the toilet seat cover. Please make sure that the installation procedure is held by professional specialist. Before starting the ballast of the UV-C lamp please check the following points:

Please ensure that the electricity power supply is not different than 220V,230V,240V according to each specific country.

Ensure you that the electricity net is prevented against sudden change in voltage or thunderstorms with a circuit breaker and bipolar breaker. Please ensure that there is a grounded cable and it is not damaged.

Quartz sleeves and uv lamp should be handled with cotton gloves in order to do not modify the surface.

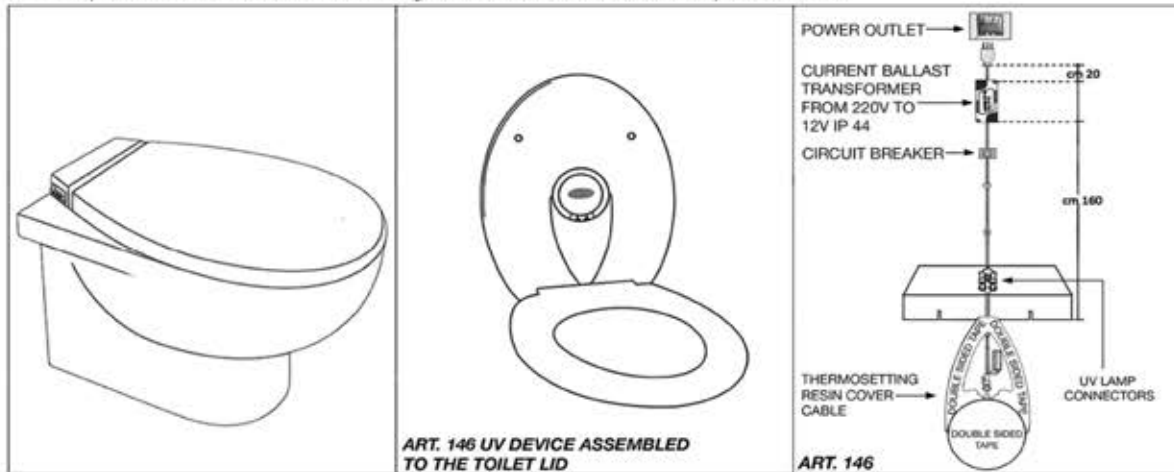

ART.146 UV DISINFECTION SYSTEM FOR TOILET SEAT COVER. IT ALLOWS TO ELIMINATE UP TO 99% OF ALL VIRUSES AND BACTERIA COMING FROM THE SEWER PIPE AND SPREADING ALL OVER THE SANITARY SURFACE AND BATHROOM ENVIRONMENT.

**ART 146: VIRUS FREE TOILET SEAT LID, EQUIPPED WITH UV-C GERMICIDAL LAMP (LAMP AVERAGE LIFE OF 9000 HOURS). IT ALLOWS THE ABATEMENT OF UP TO 99% OF ALL VIRUSES AND BACTERIA THAT COMING FROM THE SEWERAGE, HEY POP UP TO THE DRAINAGES'PIPES AND SPREAD ALL OVER THE SURROUNDING ENVIRONMENT.**

### INSTALLATION FRAME

- Wipe with a soft cloth that has been soaked into pure alcohol the toilet seat cover and toilet faucet surface to eliminate any trace of dirt and grease.
- Locate the cover carter including the lamp holder on the inner surface of toilet seat cover. Leave the double side tape film and make sure to locate the disinfection system on the right position as in the picture 1. Please locate the backside box containing the electrical components behind the toilet seat and fix it thanks to a double side tape on the lower surface of the box.
- Connect cables of the lamp with those into the backside box and fix the toilet seat cover to the wc. Plug the system.
- Prepare the hinges of toilet seat cover and fix it to the WC, paying attention to let the base of the backside box perfectly matches with the metal hinges.
- Plug the system and connect the cable to the electricity power supply.

## LAMP REPLACEMENT AND MAINTENANCE

Varm disinfection system for WC is composed by certified items which comply with IP 44 (International Protection Marking). The complete set of electrical components are protected against splashing water sprayed at all angles, steam and for the drop of items that volume is equal of 1 mm such screws and most wires.

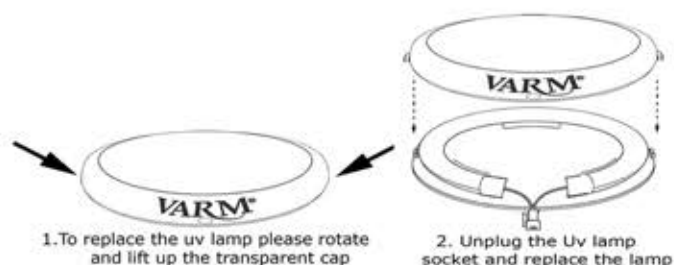

**WARNING : IT MUSH DISCONNECT THE SYSTEM FROM THE ELECTRICITY NET BEFORE ANY KIND OF OPERATION ON IT**

## WARNING AND SAFETY PRECAUTIONS

### WARNING

- Do not plug or unplug the power plug with wet hands.
- Do not get any water or cleaning solution on the top unit or power plug.
- Never disassemble, repair or alter.
- Do not use Varm UV disinfection system if a malfunction occurs. Always unplug the plug from the outlet.
- Do not touch the power plug during thunderstorms.
- Do not use a loose and faulty electrical outlet, do not use any outlet or wiring equipment beyond its specified rating.
- Do not use any power supply other than the one specified.
- AC 120v, 60Hz
- AC 220, 50Hz/60Hz
- Keep cigarettes and other open flames away from the product.
- Avoid spurts of water.
- Always disconnect the power plug from the outlet before cleaning, maintenance or inspection.
- Periodically remove dust and dirt from the electrical plug and make sure it is securely plugged into the wall outlet.

### SAFETY PRECAUTIONS

- Do not use the product if the toilet seat cover is unstable.
- Do not apply strong force, mechanical shock, step or stand on the toilet seat, toilet lid or on the backside box. Also do not place any heavy object on the toilet seat, toilet lid and backside box.
- In the product is damaged, do not touch the damaged section.
- CAUTION: improper use of toilet seat may cause irritation and burn. When sitting for a long time on the toilet seat, avoid to touch the UV lamp holder located on the inner surface of toilet seat cover. When any of the following people use the system the assistance by another person is greatly suggested.
- young children, the ill, physically disabled and who do not have freedom on movement, those who have been drinking heavily, anyone severely fatigued and anyone else liable to fall asleep.
- Varm UV disinfection system for WC starts to functions when the toilet seat cover has been closing for the us, for this reason pay attention to do not look directly at UV light.
- Use this product only for its intended use as described in this manual. Do not use attachments not recommended by the manufacturer.
- Never operate this product if it has damaged cord or plug, is not working properly, has been dropped or damaged. Return the product to the service center for examination and repair.
- Keep the cord away from the heated surfaces.
- Do not use while bathing.

## 5. NOTE AND WARRANTY

The manufacturer declares to respect all the laws concerning the safety. The device should be operated only in conformity described by the present manual. In case of no respect of the above prescription, warranty covered by the manufacturer will be excluded. The user should notify the date of starting of activity of the present device which will be taken as reference date for the warranty coverage. In case you fail to register the date the warranty coverage will start from the device invoice receipt. In case of some inconvenient due to an incorrect installation will occur, the customer is responsible for the payment of the maintenance service offered by the concerning agency. Warranty covers all components of the device and it includes the reparation and/or if necessary, the replacement of each singular components of the device for free, which according to Varm Assistance Service Staff opinion they present some conformity defaults. Warranty does not cover defaults of esthetic of items subject to usury and damages that are not caused by the manufacturer as for example: transportation, incorrect installation, incorrect maintenance, alterations, sudden changes in voltage, thunderstorms, excess of humidity, accidental shock or due to extenuating circumstance. The validity of warranty depends on the fact that the installation procedure, the maintenance and use of the device will be done in accordance to prescriptions provided by Varm. Varm refuse any responsibilities for damages shall directly or indirectly occur to people, things and animals from the incorrect functioning of the device.

## CERTIFICATION

Varm uv disinfection system for wc complies with all concerning CE directives on uv disinfection systems and each of its components has the CE mark. CE (European Conformity) for disinfection system

Manufactured and assembled by: Varm SRL

The product is SUITABLE to be applied into private homes, hospitals, hotel, schools, gyms etc.

Type: Uv disinfection system for toilet faucet. Regulation 2004/108/EC (EX 89/336/EEC) Electromagnetic Compatibility

**DIN EN 55015-2008-04 Limits and methods of measurement of radio disturbance characteristics of electrical lighting and similar equipment.**

**EN 61547:1996-07+ A1:2000-12** (Emc prescription for immunity) - **EN 61000-3-2** (Limits for harmonic current emissions)

**IEC 61000-3-3:1994** (Limitation of voltage fluctuations and flicker in low-voltage supply systems for equipment with rated current 16 A)

- EN 62493-2010 (assessment of lighting equipment related to human exposure to electromagnetic fields)
- Regulation **The Low Voltage Directive (LVD) 2006/95/EC**
- DIN EN 60335-2-7-2010 (Household and similar electrical appliances - Safety - Part 2-7: Particular requirements for washing machines)
- DIN EN 61347-2-12-2011 (Particular requirements for d.c. or a.c. supplied electronic ballasts for discharge lamps (excluding fluorescent lamps))-BS EN 61347-1-2008+A2-2013 (Lamp controlgearGeneral and safety requirements
- DS/EN 60669-2-1/A1-2009 (Switches for household and similar fixed electrical installations)
- DIN EN 60669-1 Berichtigung 1-2010 Switches for household and similar fixed-electrical installations - Part 1: General requirements
- En 61199.1999 en 61199:2000 (Single-capped fluorescent lamps. Safety specifications)
- Regulation 2011/65/ EU RoHS Directive - En 60529:1991/A1:2000 (EN 60529-1991 Degrees of Protection Provided by Enclosures (IP Code))-UNI EN ISO 9001:2008 (Quality management system certificate)Dichiarazione di conformità.

For additional information:

**REVIEW 1  
MAY 2015**

**VARM SRL VIA GALILEO GALILEI 2/4 01033 CIVITA CASTELLANA VT**

**TEL +39 0761 540095 FAX +39 0761540257 info@varmforigiene.com www.varmforigiene.com**